

HDL-P287

Rhythmus Outdoor Speaker P287

Datasheet

Issued: April 28, 2022

File Edition: V1.0.1



Figure 1. HDL-P287 speaker with grille



Figure 2. HDL-P287 speaker without grille

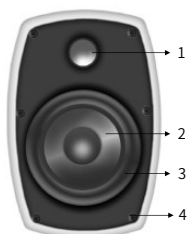

Figure 3. Components - Front View

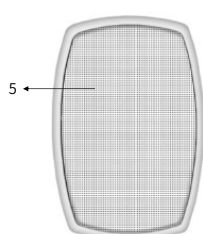

Figure 4. Components - Front View

Bare Wire Connection

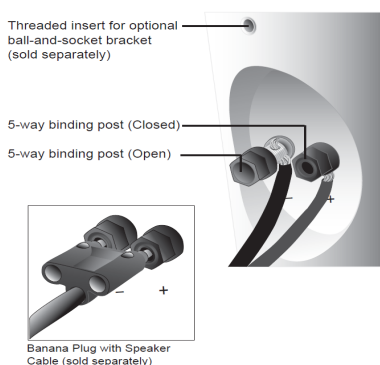

Figure 5. Bare wire connection

Wall-Mount Speaker Bracket

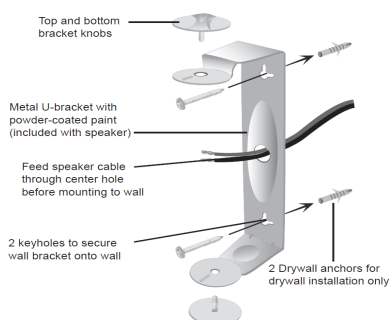

Figure 6. Wall-mount speaker bracket

Overview

Rhythmus Outdoor Speaker P287 (See Figure 1 and 2) is designed to accurately reproduce high fidelity music in an outdoor environment. It produces crisp highs necessary for an outdoor situation as well as a surprising amount of bass given their compact size. Rhythmus Outdoor Speaker P287 is waterproof and built to last through all seasons. All exposed screws are stainless steel and the aluminum grille is powder-coated so rust is not an issue. The cabinet is made of a high-impact ABS polymer and includes paint with UV protection. The primary components include a polypropylene driver with a butyl rubber surround and a PEI tweeter that hold up under extreme temperature fluctuations.

Features

See Figure 3 and 4

1. 1" PEI tweeter for clear highs and long outdoor life.
2. 6.5" polypropylene cone for smooth mids and bass.
3. Butyl rubber surround ensures a long life.
4. Stainless steel screws will not rust
5. Powder-coated aluminum grille will not rust, and micro-mesh design keeps rain out.

Important Notes

- You will achieve the best stereo sound and imaging if you mount both speakers along the same wall between 7 and 15 feet apart.
- Make sure the material on which you plan to mount the speakers can support the weight of the speakers.
- Never attach the speakers to a wall that might contain electrical wiring or plumbing.
- It is recommended to use a "drip loop" when installing your speaker cable to help minimize the direct flow of water onto the speaker.

Product Information

Bare wire connection - See Figure 5

Wall-mount speaker bracket - See Figure 6

Protecting Your Outdoor Speaker with a "Drip Loop" Figure - See Figure 7

Installation steps are as below:

1. Using the "keyhole" slots in the U-brackets as a guide, mark where the two screws will be installed.
2. If a stud is not available behind the drywall, drill a hole slightly smaller than the diameter of the drywall anchor and insert the drywall anchor until it is flush with the wall. Drive screws into a wall stud (if available) or into the drywall anchors leaving the screw heads protruding about 1/8" from the wall. Always use two screws (and two drywall anchors if no stud is available) for each speaker.
3. Run the speaker cable into position and pull the cable through the hole in the center of the bracket before mounting the bracket. Leave an extra 18" of cable to make installation and positioning of the speaker easier.
4. With the bracket attached to the speaker (using the round bracket knobs), place the large center portion of each "keyhole" over the protruding heads of each screw. Slide the speaker and brackets down so that the screw head slips behind the smaller end of the keyhole.
5. Tug gently on each speaker and bracket to make sure that the screws and bracket are properly held snugly in place. If necessary, disconnect a speaker from the bracket, tighten the screws, and then reattach the speaker.
6. Connect the speaker cables to the speaker before connecting the other end to your amplifier: Strip approximately 1/2" of insulation away and tightly twist the wires. For both the positive and negative cable, twist open the binding post by turning counter-clockwise to reveal an "eye". Insert the wire into the "eye" and tighten the binding post back down. When connecting a speaker it is important to maintain correct polarity.
7. With the amplifier turned off, connect the other end of the speaker cable in accordance with the instructions provided with that component. Once connected, turn on the amplifier and test the speakers.

Safety Precautions



- The installation and testing for the product must be carried out by HDL Automation Co., Ltd. or its appointed service agencies. The electric construction shall comply with local laws and safety regulations.
- HDL will not be responsible for any consequence caused by the inexpert or faulty installation and wiring methods, which are not in accordance with the instructions contained in this operating instruction.
- Please do not privately disassemble or replace any parts of the product. Otherwise, it may cause mechanical fault, electric shock, fire or personal injuries.
- Please contact our after-sales departments or our designated service agencies for your maintenance service. Product failures caused by private disassembly are not subject to this warranty.

Package Contents

HDL-P287(with grille)*2 / Datasheet*1

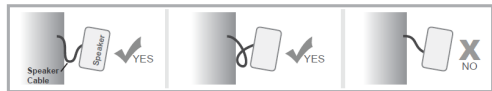

Figure 7. Protecting Your Outdoor Speaker with a "Drip Loop" Figure

Technical Data

Basic Parameters

| | |
|--------------------|-------------------------------|
| Product name | Rhythmus Outdoor Speaker P287 |
| Woofers | 6.5" polypropylene |
| Tweeter | 1" Ferrofluid cooled PEI dome |
| Impedance | 8 Ω |
| Sensitivity | 91dB@1W/1M |
| Power handling | 150 W |
| Frequency response | 40-20kHz |

External Environment

| | |
|---------------------------|------------|
| Working temperature | -5°C~45°C |
| Working relative humidity | ≤90% |
| Storage temperature | -20°C~60°C |
| Storage relative humidity | ≤93% |

Specifications

| | |
|---|------------------------------------|
| Net weight | 3.35 kg |
| Housing material | Polypropylene with aluminum grille |
| Installation | Wall mounting |
| Protection rating (Compliant with EN 60529) | IP65 |

Technical support

E-mail: hdltickets@hdlautomation.com

Website: <https://www.hdlautomation.com>

©Copyright by HDL Automation Co., Ltd. All rights reserved.
Specifications subject to change without notice.