

-L2080-

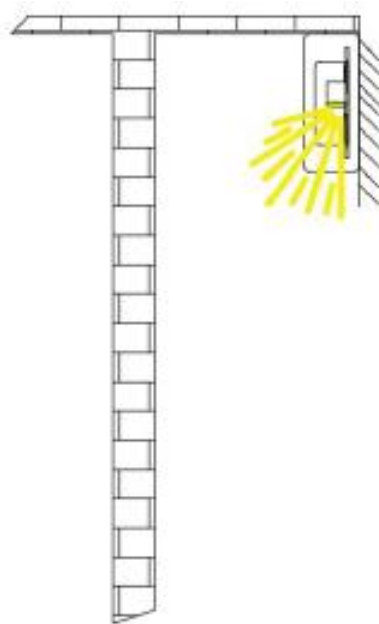

Features:

- Asymmetric lighting and Side bending
- 2835 side lighting LED inside
- Diffused silicone extrusion
- UV and yellowish resistant
- IP20 and salt-mist proof
- L70B50 > 50,000hrs
- Easy installation and re-connect accessories
- 1025lm per meter @4000K
- ~9.6W/mtr, continuous length 10mtrs
- Bending radius 5cm

Benefits:

- ✓ Enhanced 2835LED for flexible application
- ✓ Asymmetric light distribution

Application:

- Indoor or outdoor curved wall washer

L2080 - product configurations

Item	Input Voltage	Driving mode	Power/m	Lm/m	Available Color	Max. length (Single-end power feeding)	Cutting unit	LED Qty/m
L2080	DC24V	Constant Voltage	9.6W/m	1025lm@4000K	2700K/3000K/3500K/4000K/5000K/ Red/Green/Blue	10mtrs	50mm	120LEDs/m

Notes:

1. Only common products listed, if other configurations needed please contact with factory.

L2080 - Accessories

- ◆ For installation:

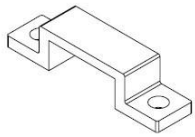

3M tape or plastic clips

- ◆ For Connection type 1 – IP20 molded power feeder

