

# Track-mounted Spotlight(three wire)

## Datasheet



HD-GD3001F



Please scan the QR code above to check the latest version of datasheet!

Before using this product, please read this datasheet carefully and keep it properly!

Document Version: C

---

## ◆◆ Overview

**Track-mounted Spotlight(three wire)** is a flicker-free LED light with constant current. The housing material is aluminum alloy and has a novel structure.

Mainly suitable for indoor places such as hotels, luxury homes, clubs, model rooms, sales offices, museums, restaurants, shopping malls, shops, etc. that require special lighting.

**Note:** Please note that the pictures and illustrations provided in this instruction manual are for reference purposes only, and the actual product may differ.

## ◆◆ Appearance



Figure 1

## ◆◆ Technical Data

Item	Parameter
<b>LED</b>	
Fixed color temperature	2700K/3000K/3500K/4000K/5000K
CRI	>90
<b>Optics</b>	
CCT light beam angle	16°/26°/36°
<b>Power supply parameters</b>	
LED driver	ON-OFF driver
LED power	10W
Supply voltage	220V

## ◆◆ Specifications

Item	Parameter
Dimensions	Ø50mm
Height	125mm
Weight	250g
Installation site	Indoor
Type	Spotlight
Installation	Install onto the track
Version	Round
Housing	Black, white
IP degree (compliant with EN 60529)	IP20

## ◆◆ Safety Precaution

### **Danger:**

- Please do not privately disassemble or replace any parts of the product. Otherwise, it may cause mechanical fault, electric shock, fire or personal injuries.
- Under no circumstances should the product be covered by insulation pads or similar materials.

### **Warning:**

- The installation and testing for the product must be carried out by HDL Automation Co., Ltd. (hereinafter referred to as HDL) or its appointed service agencies. The electric construction shall comply with local laws and safety regulations.
- HDL will not be responsible for any consequence caused by the inexperienced or faulty installation and wiring methods, which are not in accordance with the instructions contained in this datasheet.
- Please contact HDL after-sales departments or our designated service agencies for your maintenance service. Product failures caused by private disassembly are not subject to the warranty.

### **Caution:**

- Before performing any installation or disassembly procedures on the device, it is crucial to disconnect the device from all voltage sources. This step is necessary to ensure the safety of the technician and prevent any potential damage to the device.
- Do not use corrosive liquid to wipe the device body, especially the interface, so to avoid damage to the device. Do not wipe the device with a damp cloth.
- Before performing any maintenance or cleaning procedures on the device, it is imperative to disconnect the device from all voltage sources. This precautionary measure is necessary in order to prevent electric leakage and the risk of electric shock.

- After all of the cables are terminated, check for correct and good terminations.
- Overrange is not allowed. Please use the device in accordance with the technical specifications.

**Note:**

- The use of this product must not violate any safety regulations, and the product must be 800mm away from the illuminated object.
- Ensure that this product is securely fastened to the surface of the installed object and not installed on ceilings that are easily damaged or deformed.
- In order to extend the service life and maintain the best lighting effect, it is recommended to regularly clean and maintain the product.

## ◆◆ Installation

**Warning:** Before performing any installation or disassembly procedures on the device, it is crucial to disconnect the device from all voltage sources. This step is necessary to ensure the safety of the technician and prevent any potential damage to the device.

**Implementation standards:** GB/T 17743-2021; GB 7000.1-2015;GB 7000.202-2008

**Step 1:** Rotate the clamping switch to the back side, so that the conductive copper sheet is hidden inside the connector;

**Step 2:** Align the guide label on the lamp connector with the groove on the guide rail, and then insert it into the slot of the guide rail;

**Step 3:** Rotate the clamping switch to the front to firmly secure the light on the track;

**Step 4:** Turn the power switch to the "ON" position and adjust the light head to the appropriate position towards the illuminated object;

**Step 4:** Before powering on, please ensure that the wiring is correct and that the light will not loosen.

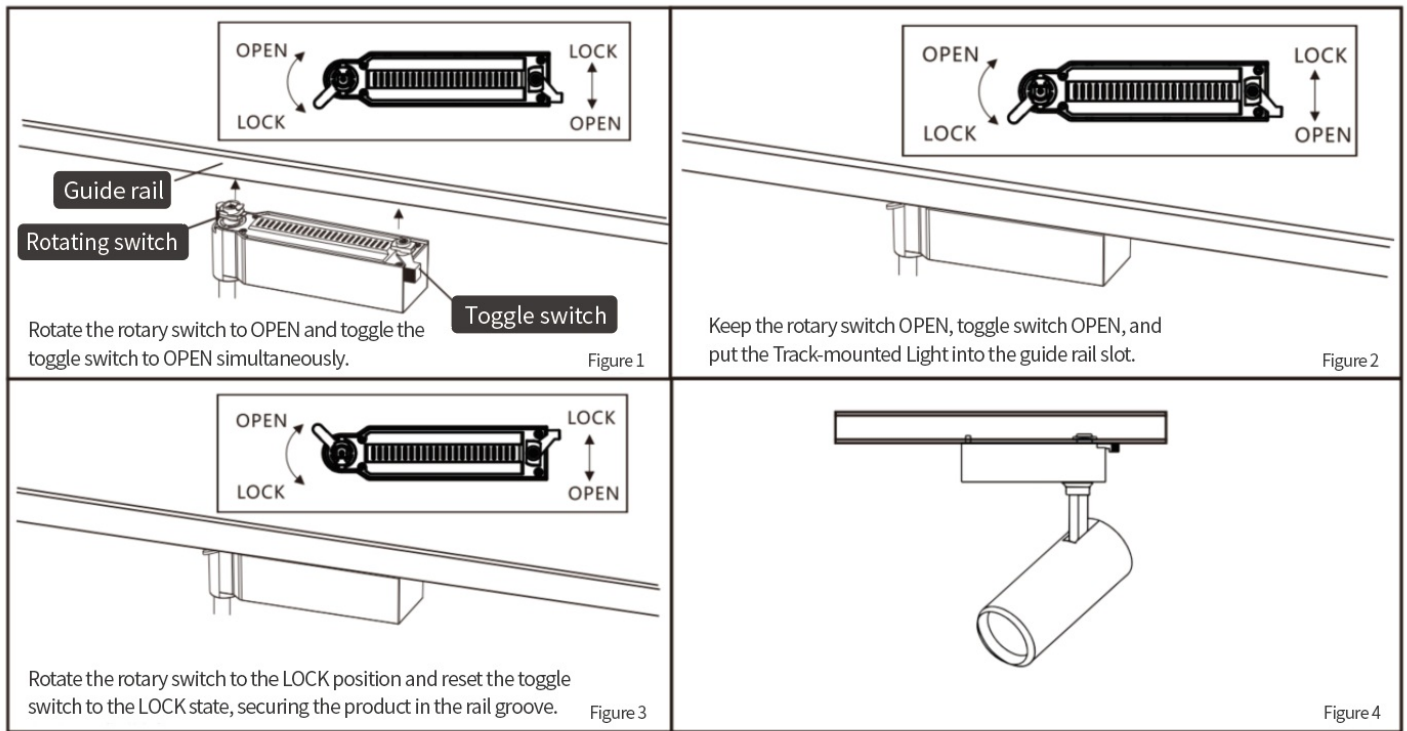

## ◆◆ Disassembly

**Warning:** Before disassembling, please cut off the power supply, and operation with electricity is prohibited.

## ◆◆ Packing List

- Track-mounted Light\*1

**Note:** After unpacking, please check if the product and the parts are complete.

## ◆◆ Copyright Statement

HDL has all the intellectual property rights to this document and contents thereof. Reproduction or distribution for third parties are prohibited without written authorization from HDL. Any infringement of HDL's intellectual property rights will be investigated the legal liability.

The contents of this document will be updated as the updates of product versions or other reasons. Unless otherwise agreed upon, this document is to be used as a guidance only. All the statements, information and recommendations in this document makes no warranty expressed or implied.

© 2025 HDL Automation Co., Ltd. All rights reserved.

**Update History:**

The form below contains the information of every update. The latest version contains all the updates of all former versions.

Version	Update Information	Date
V1.0	Initial release	Sept 30, 2025

◆◆ Technical Support

E-mail: [hdtickets@hdlautomation.com](mailto:hdtickets@hdlautomation.com)

Website: <https://www.hdlautomation.com>