

Fingerprint Smart Door Lock

Instruction Manual



MODF-Lite3-LK.10

Before using this product, please read this manual carefully and keep it properly!

Document Version: C

◆◆ Overview

Fingerprint Smart Door Lock (hereinafter referred to as the “product” or “device”) is an IoT smart door lock that supports multiple unlocking methods such as fingerprint, password, Bluetooth, NFC, and mechanical keys.

◆◆ Appearance

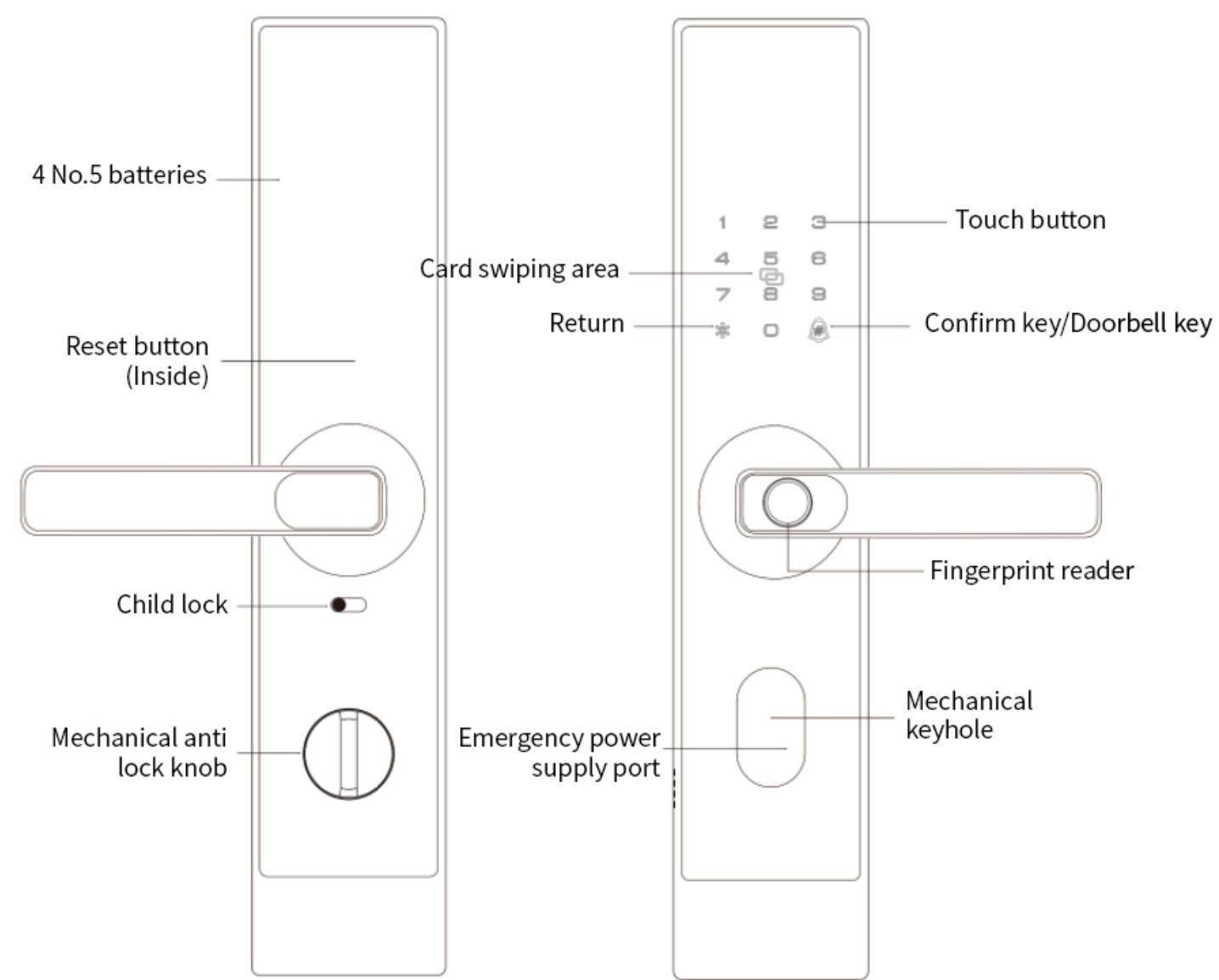

◆◆ Technical Data

Item	Parameter
Communication protocol	Link protocol: Buspro, Zigbee and KNX
Lock cylinder type	Class C
Lock body type	Mechanical lock

Unlocking method	Fingerprint / password / proximity card / mechanical key / mobile app authorized temporary password / dual authentication
Door handedness	Left / right hand
Password	Virtual Password: Supports up to 32 bits (including correct password) Temporary Password: Supports
Key capacity	Fingerprint capacity: 50 Password capacity: 50 Proximity card capacity: 50
Fingerprint reader	Semiconductor
Fingerprint reader recognition speed	< 1s
Alarm	Anti disassembly alarm / low battery alarm / anti test opening lock (password and card verification fail 3 times in a row within 5 minutes, fingerprint verification fails 5 times in a row, system lock for 3 minutes) / Stay detection
Working power supply	4 No.5 batteries
Emergency supply	Type C
Working temperature	-25°C~70°C
Working relative humidity	< 93%

◆◆ Specifications

Item	Parameter
Dimensions	360*73*23mm
Color	Black / gold
Door width	40mm-120mm
Doorbell	Digital doorbell
Endurance	6-8 months
Housing material	Aluminum alloy
Iron hook	Support
Big lock	Support
Installation	Suitable for iron and wooden doors

◆◆ Safety Precaution

1. The NFC technology used in this product meets the technical requirements of Class C general micro power devices in the "Catalogue and Technical Requirements for Micro Power Short Range Wireless Transmission Devices", and is used for data transmission applications. Please refer to the relevant content in the product manual for instructions on how to use the integrated antenna, controlling, adjusting, and switching;
2. It is not allowed to change the usage scene or conditions, expand the transmission frequency range, increase the transmission power (including installing additional RF power amplifiers), or change the transmission antenna without authorization;
3. It shall not cause harmful interference to other legitimate radio stations, nor shall it provide protection against harmful interference;
4. It should withstand interference from industrial, scientific, and medical (ISM) application device that radiates radio frequency energy or other legitimate radio stations;
5. If harmful interference occurs to other legitimate radio stations (stations), the use should be immediately stopped and measures should be taken to eliminate the interference before continuing to use;
6. The use of micro power device in aircraft and in electromagnetic environment protection areas designated in accordance with laws, regulations, relevant national provisions, and standards, such as radio observatories, meteorological radar stations, satellite earth stations (including measurement and control, ranging, reception, navigation stations), military and civilian radio stations (stations), airports, etc., shall comply with the regulations of electromagnetic environment protection and relevant industry regulatory authorities;
7. It is prohibited to use various model remote controllers within a radius of 5000 meters from the center point of the airport runway;
8. The operating temperature of micro power devices is $-25^{\circ}\text{C}\sim+70^{\circ}\text{C}$.

◆◆ Wiring

Connect the data cable to the rear panel interface and press it tightly.

◆◆ Installation

Click on the following link to view the installation video:

<https://crm.hdlcontrol.com/#!/documentCenter/dataBankInfo?materialId=1889145247130148865&pathCode=dataBank>

Installation steps instructions:

Note: The thickness of the door must be 40mm-120mm.

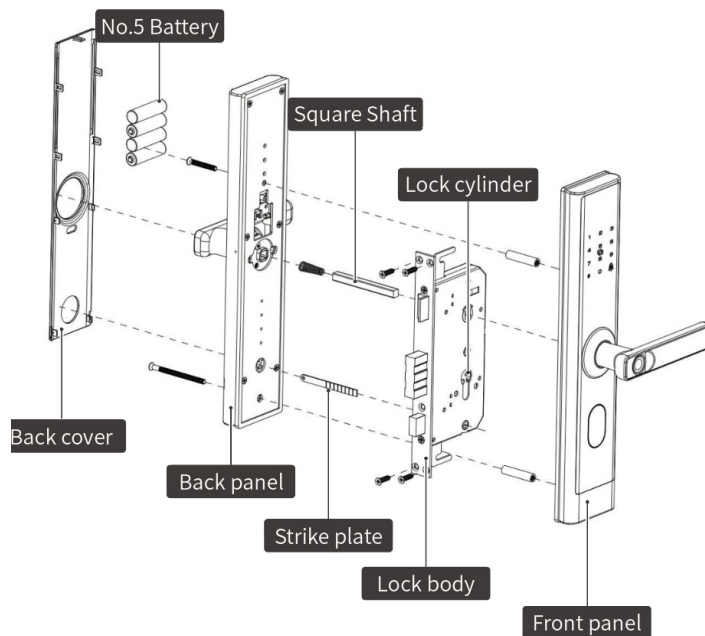

- Step 1. Prepare tools and materials: screwdriver, ruler or tape measure, installation template, electric drill (may be required);
- Step 2. Align the door edge line on the template with the door edge, and refer to the template to make a hole on the door;
- Step 3. Install the door latch plate on the side of the door frame and tighten the screws;
- Step 4. Insert the lock body into the door, insert the lock cylinder into the lock body, and fix the lock cylinder with screws;
- Step 5. Insert the square shaft into the front panel, fix the front panel and square shaft to the lock body, and thread the data cable through the hole on the door;
- Step 6. Connect the strike plate to the back panel, connect the data cable to the back panel interface, and press the square shaft into the corresponding hole on the back panel;
- Step 7. Install the upper and lower screws to secure the panel;
- Step 8. Install the battery and tighten the back cover with screws;
- Step 9. Installation completed, test opening the door.

◆◆ Operation

Note: After the installation of the door lock is completed, please open the back cover of the inner lock and put in 4 No. 5 dry batteries;

For more operations, please refer to the actual broadcast menu of the door lock. After completing the settings, please download the APP as soon as possible to use more functions.

1. First use

Operation	Menu
-----------	------

Enter 1	Enter the administrator user settings and set either fingerprint or password, or both as the password to use
Enter “*#”	After entering the settings page and verifying the administrator's identity, you can perform management user settings and common user settings
Enter 2	Common user settings include fingerprint settings, password settings, card settings, and clearing users
Enter 3	Enter system settings: If device binding is required, enter 1 to perform the binding operation. After the binding result is returned, a voice prompt will appear saying "start binding", and then you can perform pairing operation on the APP; If you need to unbind the device, enter 2 to unbind the device
Enter 4	Enter 1 to set the doorbell volume and enter 2 to set the system volume; According to actual needs, high, medium, and low frequencies can be set separately
Enter 5	Enter language setting: Enter 1 to display Chinese, and 2 to display English

1.1. Common user settings

Common user settings include fingerprint settings, password settings, card settings, and clearing users.

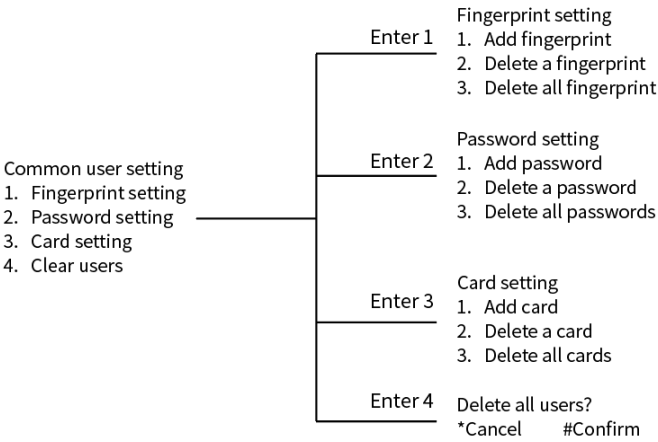

1.2. Network configuration

Tip: Before debugging and commissioning, please prepare related hardware and software.

Software	Hardware
HDL Studio APP account with commissioning authorization; Computer with HDL Studio(V1.9.47 or above) and mobile phone with HDL Home(V1.3.1 or above)	Fingerprint Smart Door Lock (Model: MODF-Lite3-LK.10)

Download HDL Home: Please scan the QR code below to download HDL Home, or search for and download the application in the app market.



Scan the QR code to download HDL Home

Step 1. Press * #, then enter the administrator password to enter the management mode, and then press 3 to enter the network configuration;



Step 2. Log in to HDL Home, add the device, and connect to the local WIFI;

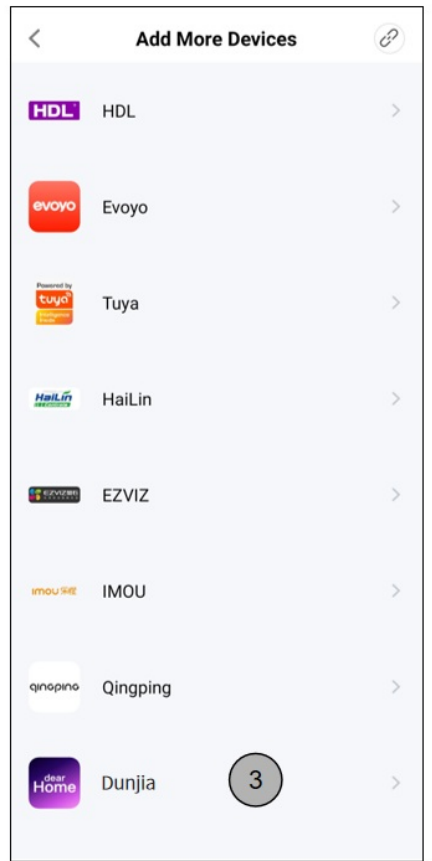
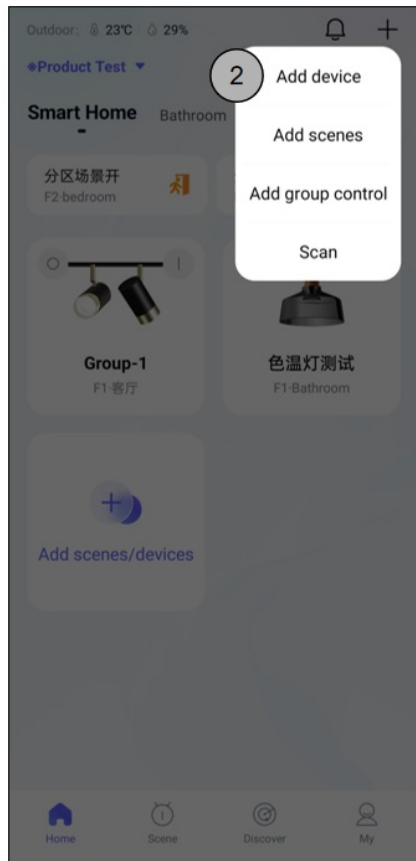
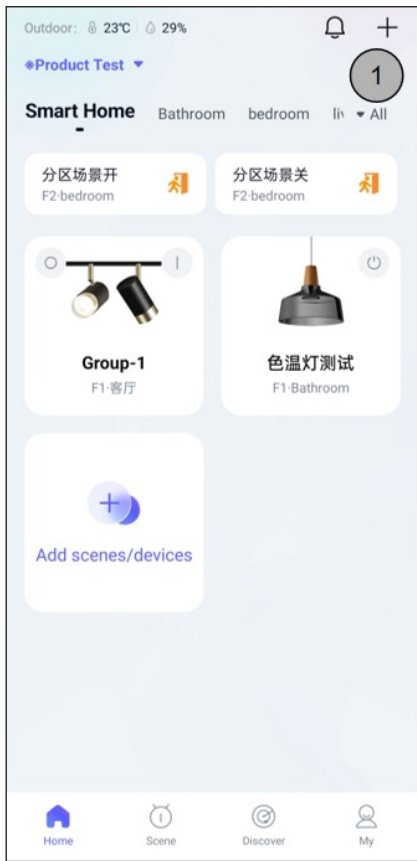

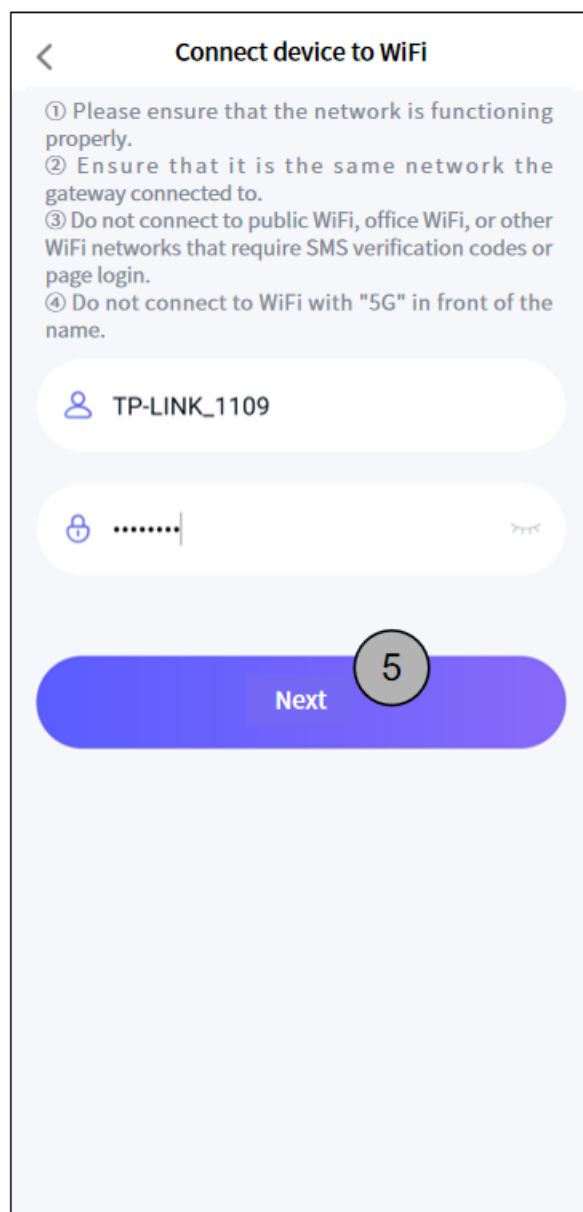
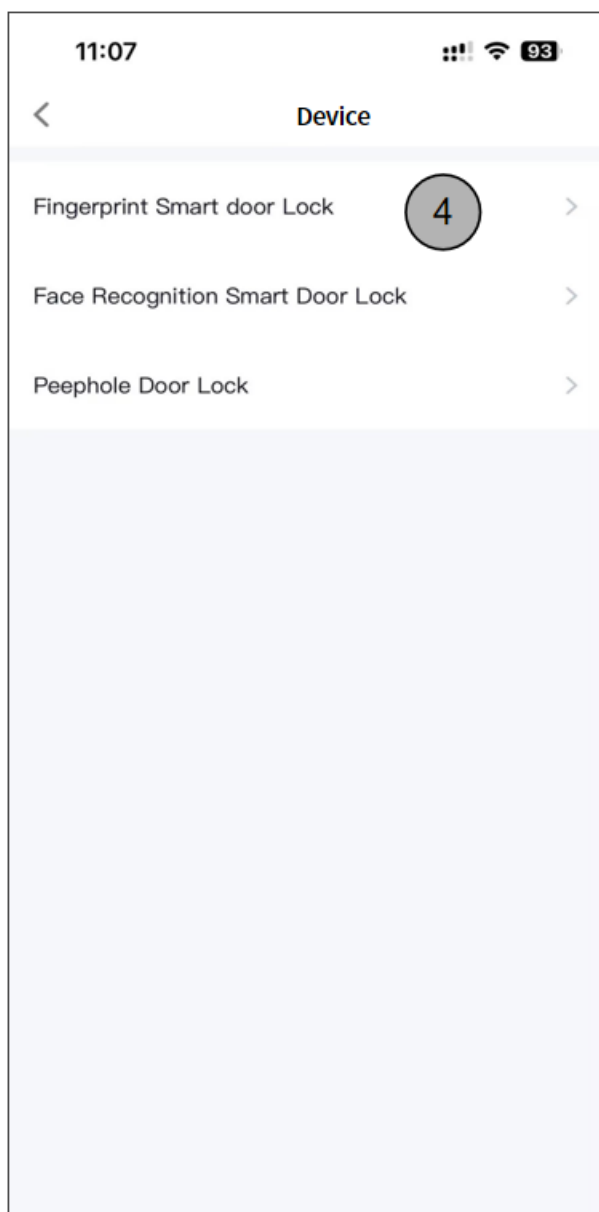

Step 3. Click Next to copy the device hotspot password; Connect to the hotspot;

Note: The device hotspot name and password are for reference only. Please refer to the actual situation when operating.

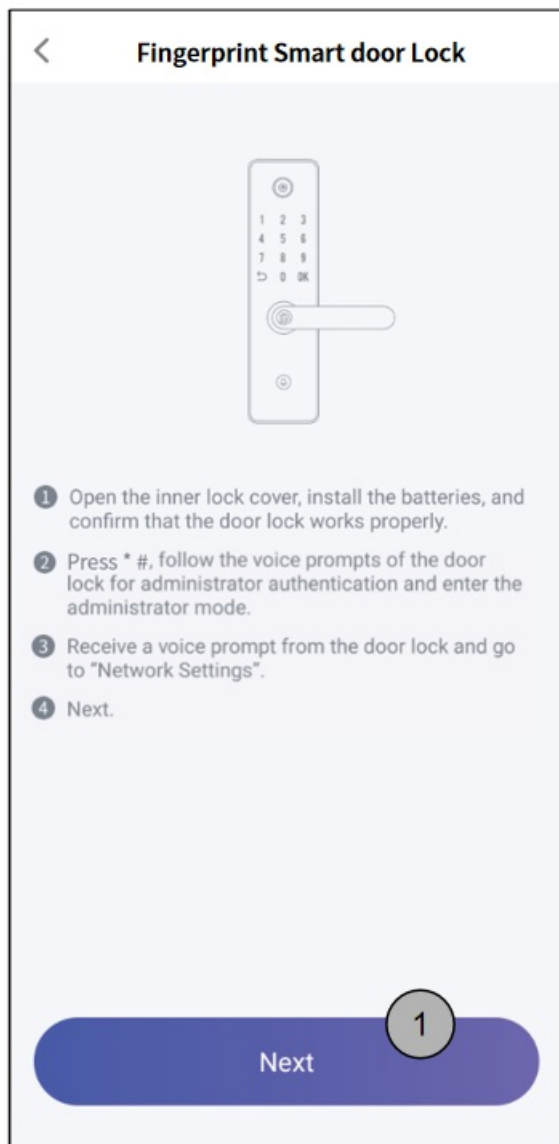

Step 4. After the device is successfully connected, click "Add to Gateway". Network configuration is complete.

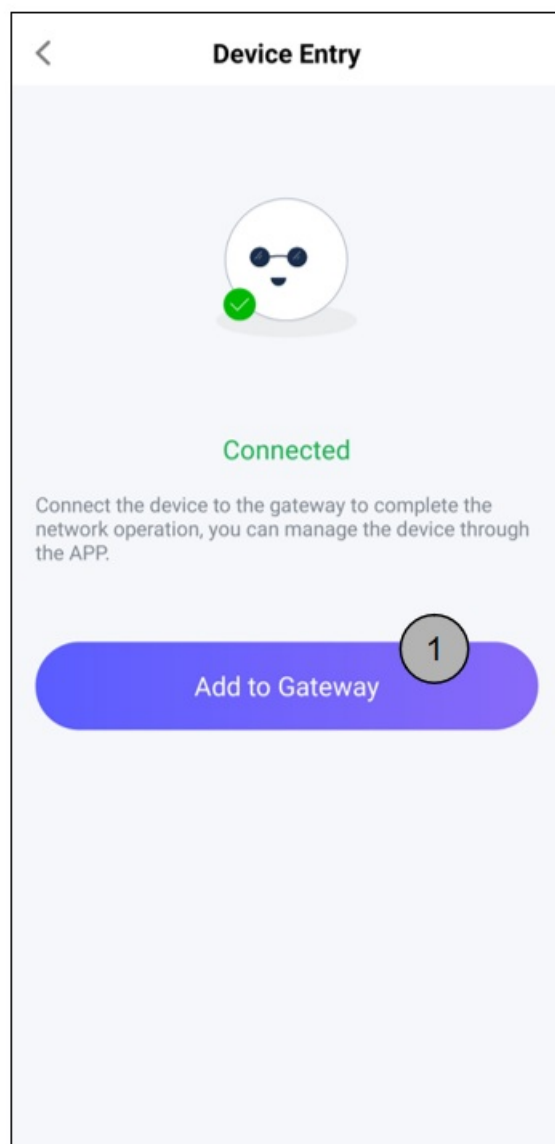
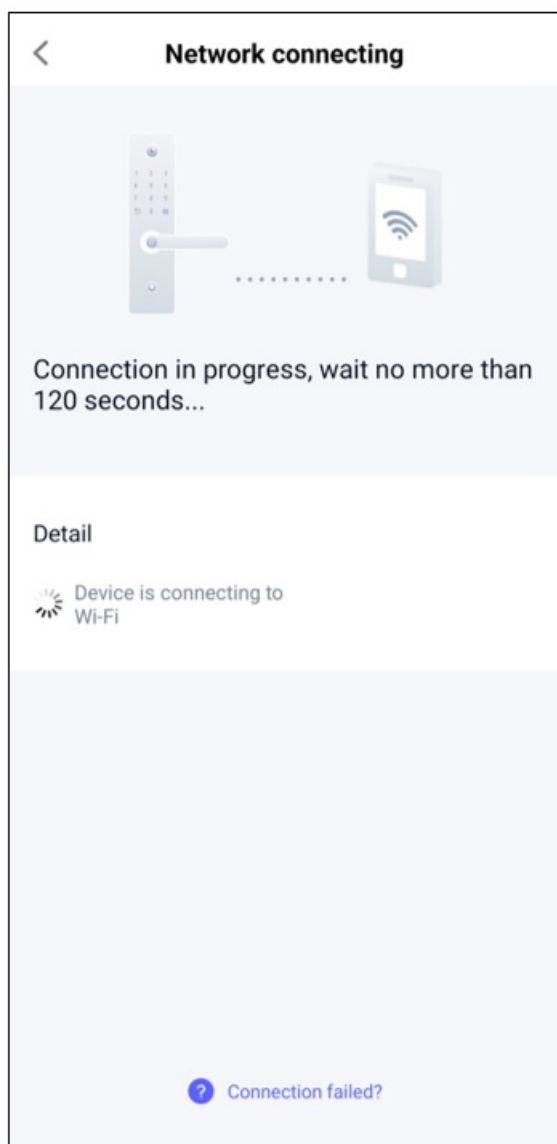

2. Restore factory settings

Function	Operation procedure
Restore factory settings	If you forget your password, you can open the internal lock back cover, press the reset button with a needle for 5 seconds, and confirm by short pressing the "#" key according to the voice prompt

3. Daily use

Function	Operation procedure
Daily use	Use one of the pre-set fingerprints, passwords, or cards to verify and open the door.
Temporary password	Enter "9 #" to open the door and start the temporary password service. Then enter the temporary password and press the "#" key to confirm;
Virtual password	The virtual password "9 #" can be preceded by up to 4 virtual passwords. For example, enter "XXXX9#12345678#" to open the door, where "12345678" is a temporary password string and "XXXX" is any number that can be added or not.
Emergency power supply	If the emergency power supply is completely disconnected from the door lock, a mobile power source such as a power bank can be used to provide power through the emergency power supply port, and then fingerprint, password, or card can be used to open the door. After successfully opening the door, please replace the battery as soon as possible.

Forced demolition alarm	When the alarm lock is forcibly removed, the lock will sound an alarm for 60 seconds.
Blocked after failed attempts	Blocking conditions: Password and card verification failed 3 times in a row within 5 minutes, fingerprint verification failed 5 times in a row, and the system is locked for 3 minutes. Contact lock: Wait for the locking to end and authenticate again.
Low battery alarm	When the battery is low, it is recommended to replace it before use.

◆◆ Packing List

- Front panel * 1
- Rear panel * 1
- Mechanical lock body * 1
- Installation accessories package * 1 (two bamboo bolts; one square shaft; two casing tubes; one lock cylinder pick; one long screw; four short screws)
- Lock cylinder package * 1
- No.5 battery * 4
- Installation template * 1
- Lock body strike plate * 1
- NFC card * 2

◆◆ Warranty

In the following cases, HDL regards the user as giving up the relevant services promised under the warranty and the user shall bear the corresponding responsibility and shall not be entitled to the free warranty:

- Failure of the device caused by force majeure factors.
- The user has placed the device in a transportation or use environment that does not comply with the statements in the product instructions or technical manuals.
- Unauthorized disassembly of the product by the user.
- Promises not made officially by HDL to the user that are beyond the scope of the warranty are the responsibility of the promisor.

HDL reserves the right to update or change the product without prior notice to the user, please visit the HDL website for answers to your questions and the latest product information.

The final interpretation right of the warranty regulations belongs to HDL.

◆◆ Copyright Statement

HDL has all the intellectual property rights to this document and contents thereof. Reproduction or distribution for third parties are prohibited without written authorization from HDL. Any infringement of HDL's intellectual property rights will be investigated the legal liability.

The contents of this document will be updated as the updates of product versions or other reasons. Unless otherwise agreed upon, this document is to be used as a guidance only. All the statements, information and recommendations in this document makes no warranty expressed or implied.

© 2024 HDL Automation Co., Ltd. All rights reserved.

Update History:

The form below contains the information of every update. The latest version contains all the updates of all former versions.

Version	Update Information	Date
V1.0	Initial release	December 20, 2024

◆◆ Troubleshooting

E-mail: hdltickets@hdlautomation.com

Website: <https://www.hdlautomation.com>